



SAUJANA
JAYA



FREESIA

2-STOREY TERRACE HOUSE

双 层 排 楼

A PLACE TO BELONG



A GRATIFICATION OF THE SENSES

感官之悦

When the home is nestled amongst the lush greenery of Saujana Jaya, separating play and rest from work is just a fine distinction. It's unlike city living, and yet still close to it.

居住在绿悠悠的家乐园，将娱乐，栖息与工作分开，但却又仅一线之差。它与城市生活不同，但保留了一切便利。



THE PLACE TO LIVE, PLAY & GROW WITH YOUR LOVED ONES

一个让您和所爱的人一起生活，玩乐及成长的新镇

It's a place for love, laughter and sweet memories. Find yourself in the neighbourhood that brings you pleasure with all the comforts of life. A place of refuge from the mad whirl of city life. This is the place where you can create your own personal haven of bliss.

Introducing, Freesia.

一个充满着爱，欢笑和美好回忆的地方。让您生活回到原点，从新体会最简单的快乐。一个让您远离喧哗的城市生活的优质居住环境，也是一个让您能为家人打造幸福家园的地方。

崭新推介，Freesia。

4 Bedrooms
卧室

3 Bathrooms
浴室

Land Size
土地面积 **20' x 70'**

Built-up Area
建筑面积 **1,750** sq.ft.
平方尺



PLANNED FOR AN UNRESTRICTED LIFESTYLE

为无约束的生活而打造

FLOOR PLAN | 平面图

SPECIFICATIONS | 建筑规格

GROUND FLOOR
底楼



FIRST FLOOR
一楼

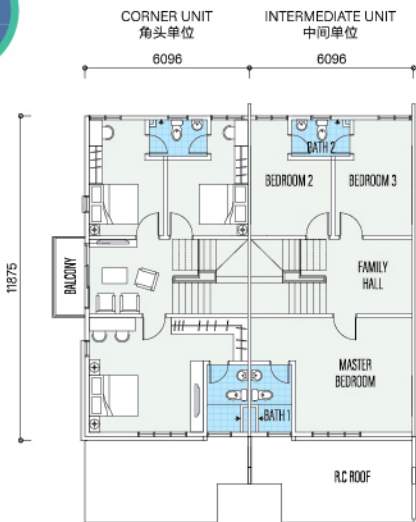

Structure

Reinforced concrete framework

Wall

Masonry wall/ reinforced concrete wall

Roof

Concrete roof tiles/ reinforced concrete flat roof

Ceiling

Skim coat/ plaster ceiling

Window

Aluminium frame window with clear/ obscured glass

Doors

Timber door (entrance door)/ plywood flush door (others)/ aluminium frame sliding door with clear glass (others)

Locks

Quality locksets

Wall Finishes

External:

Cement plaster & paint with weather resistant paint

Internal:

Cement plaster & paint with emulsion paint

Kitchen:

1500mm high ceramic wall tiles

Baths:

Ceiling height ceramic wall tiles

Floor Finishes

Concrete imprint:

Driveway, car porch

Porcelain tiles:

Living, dining

Ceramic tiles:

Family hall, bedrooms, baths, kitchen, staircase, balcony & terrace

Cement render:

Store, others.

Sanitary & Plumbing Fittings

Quality sanitary fittings

Electrical Installation

	Corner lot	Intermediate lot
Lighting point	18	16
Power points 13amp	12	12
Air-con point	1	1
Ceiling fan point	7	7
T.V. point	1	1

Internal Telecommunication Trunking & Cabling

Telephone point	1	1
-----------------	---	---

Fencing

1500mm high mild steel gate with wall/ mild steel grille (front)

1500mm high chain link gate (rear & others)

结构体

钢筋混凝土框架

墙壁

砌体墙 / 钢筋混凝土墙

屋顶

混凝土瓦 / 钢筋混凝土平屋顶

天花板

涂层抹灰 / 石膏天花板

窗户

铝框玻璃 / 蒙砂玻璃窗

门

实木木门 (大门) / 胶合板平面门 (其他) / 玻璃铝框滑动门 (其他)

锁具

优质锁具

墙面修饰

外部:

水泥涂层和耐候漆

内部:

水泥涂层和乳胶漆

厨房:

1500mm高陶瓷墙砖

浴室:

陶瓷墙砖至天花板高度

地面修饰

模压混凝土:

车道, 车房

高级瓷质砖:

客厅, 饭厅

陶瓷砖:

家庭室, 卧室, 浴室, 平台,

厨房, 楼梯, 阳台

洋灰地面:

储藏室, 其他。

卫生装置

优质卫生配件

电源装置

	角头单位	中间单位
电灯位	18	16
13amp电源插座	12	12
冷气插座	1	1
吊式风扇电位	7	7
电视插座	1	1



SAUJANA JAYA

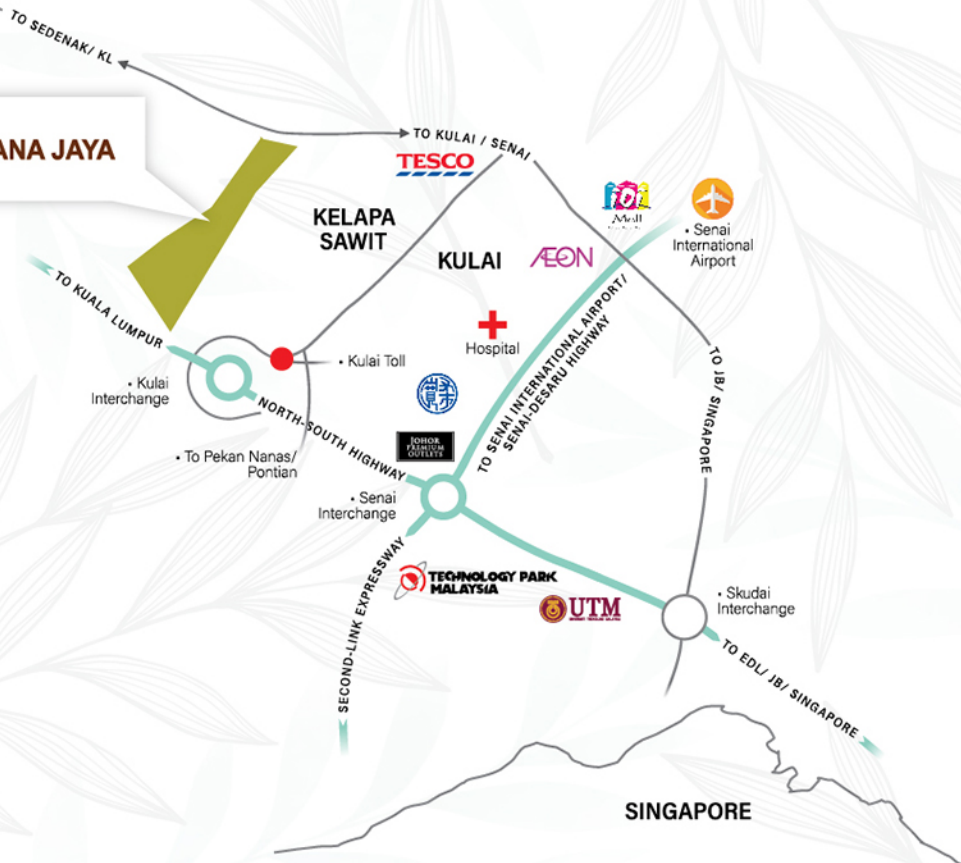

EASY ACCESS

- Adjoining Federal Route to Kulai/ JB/ KL
- 9.8km to up-coming Kulai ETS (Electric Train Services) Station (Expected to be completed by October 2021)
Source: www.mot.gov.my/en/lands/rail-transport/plbegib
- 10km to North-South Highway (Kulai/ Sedenak Toll)
- 18.7km to Second-Link Expressway
- 19km to Senai-Desaru Highway

BANKING & FINANCE

- 1km to Maybank, Alliance Bank, Bank Simpanan Nasional

SHOPPING CONVENIENT

- 7.2km to Tesco Hypermarket
- 8.7km to Econsave Hypermarket
- 13.3km to Aeon Mall Kulai
- 18.5km to Johor Premium Outlet

EDUCATION

- 1km to Sekolah Kebangsaan Polis Kem/ SMK Kelapa Sawit
- 1.8km to SRJK (C) Kelapa Sawit
- 16.6km to Foon Yew High School
- 25km to UTM (Universiti Teknologi Malaysia)
- 29km to Southern University College

交通

- 衔接联邦大道直达古来/ 新山/ 吉隆坡
- 9.8公里至古来双轨电动火车(ETS)站 (工程预计2021年10月竣工)
信息来源: www.mot.gov.my/en/lands/rail-transport/plbegib
- 10公里至南北大道 (古来/ 士年纳收费站)
- 18.7公里至马新第二通道
- 19公里至士乃 - 迪沙鲁大道

银行

- 1公里至马来亚银行, 安联银行, 国家储蓄银行

购物

- 7.2公里至特易购超级市场
- 8.7公里至宜康省霸级市场
- 13.3公里至古来永旺广场
- 18.5公里至柔佛名牌城

教育

- 1公里至加拉巴沙威警营国小/ 加拉巴沙威国民中学
- 1.8公里至四维华小
- 16.6公里至宽柔中学
- 25公里至马来西亚工艺大学
- 29公里至南方大学学院

ANOTHER PRESTIGIOUS DEVELOPMENT BY:



Developer:

PRECIOUS QUEST SDN. BHD. (560742-W) Subsidiary of Glomac Bhd (110532-M)

Sales Gallery 销售展示厅:

No. 330, Jalan Scientex 10,
Taman Scientex, 81000 Kulai, Johor.
Tel: +607-662 6160
Fax: +607-662 5161

Operating Hours 营业时间:

Monday ~ Friday : 9:00am ~ 6:00pm
Saturday, Sunday, PH : 10:00am ~ 6:00pm
星期一至星期五 : 早上9点 ~ 傍晚6点
星期六, 日, 公共假日: 早上10点 ~ 傍晚6点

For more informations, please call 欲知更多详情, 请拨电至

07-662 6160
www.glomac.com.my



Glomac Berhad



Sales Gallery
Glomac Saujana Jaya



Scan for more information