

Ruma 33

HILLSIDE RESIDENCES

A place to call your home





Enjoy panoramic hilltop views from the comfort of your home.

Bask in the breathtaking backdrop of nature as you enjoy urban living at Ruma 33. With just 33 units of 2-storey 22' x 100' terrace residences, Ruma 33 is the place to call home for those who seek tranquility and exclusivity.

Dual frontage design

A class of its own

Uniquely designed for utmost living enjoyment, the dual frontage feature is bound to bring your living experience up a notch. As you arrive home, you will be greeted by the large porch in the front side while the kitchen and master bedroom overlooks the picturesque view of green surroundings at the back frontage.





Open space layout

Personalised spaces

Enjoy the flexibility to personalise the open spaces layout according to your desire. Turn the guest room into a savvy home office or extend the back frontage to open out to the spectacular hilltop view.

**Where contemporary lifestyle
meets nature's beauty**





Connected through major highways

Highly accessible

The excellent connectivity surrounding Ruma 33 makes reaching your destinations easy and convenient. Connected highways include:

- Persiaran Mokhtar Dahari
- Guthrie Corridor Expressway (GCE)
- Sg Buloh-Kuala Selangor Latar Highway
- North Klang Valley Expressway (NKVE)
- Damansara-Shah Alam Highway (DASH)



Matured township

Live life full

The best time of your life awaits. Enjoy life to the fullest with modern amenities such as cafes, retail outlets, schools and more, all within a few steps away.

Floor plan

22' x 100' | Built-Up 2,113sqf

Specifications

Structure	Reinforced concrete framework	
Wall	Masonry / Reinforced concrete	
Roof	Concrete Roof Tiles / R.C Flat Roof	
Ceiling	Skim coat / Plasterboard ceiling	
Window	Aluminium frame window with glass	
Doors	Timber door (Entrance door) Plywood flush door (Others) Aluminium frame sliding door with glass (Others)	
Locks	Quality lockset	
Floor Finishes	Driveway, Car Porch	: Concrete Finishes
	Living, Dining, Kitchen, Guest Room	: Porcelain Tiles
	Stairs, Family Area, Bedrooms	: Laminated Timber Flooring
	Entrance, All Baths, Balcony	: Ceramic Tiles
	Utility, Apron, Others	: Cement Render
Wall Finishes	External : Cement plaster & paint with weather resistant paint	
	Internal : Cement plaster & paint with emulsion paint	
	Kitchen : 1500mm high ceramic wall tiles	
	Bath : Ceramic Wall Tiles up to Ceiling Height	
Sanitary Installation	Quality Sanitary Fittings	
Gate/Fencing	Mild Steel Gate (front), Chain link Gate (rear) Half Brick wall & Mild steel fencing Chain link fencing	
Others	Refuse compartment & letter box	

GROUND FLOOR

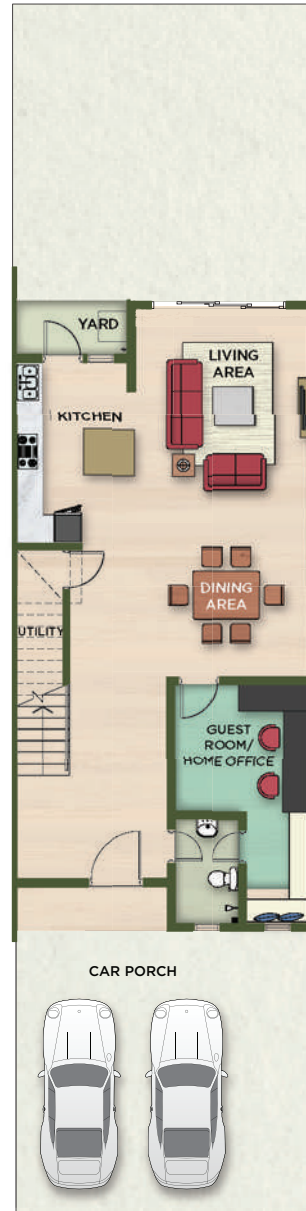

FIRST FLOOR

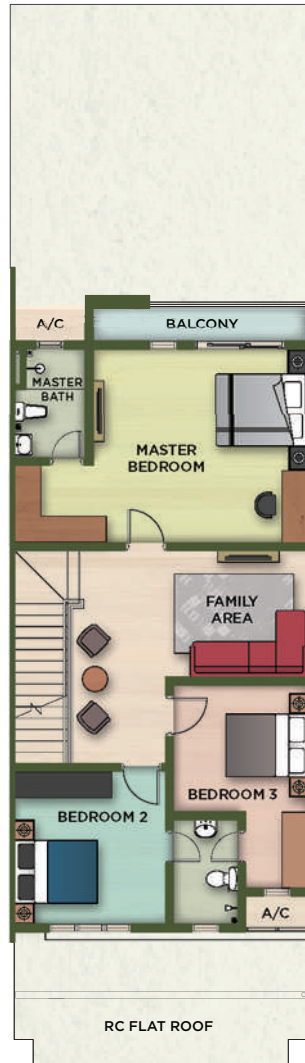

Site plan of Ruma 33

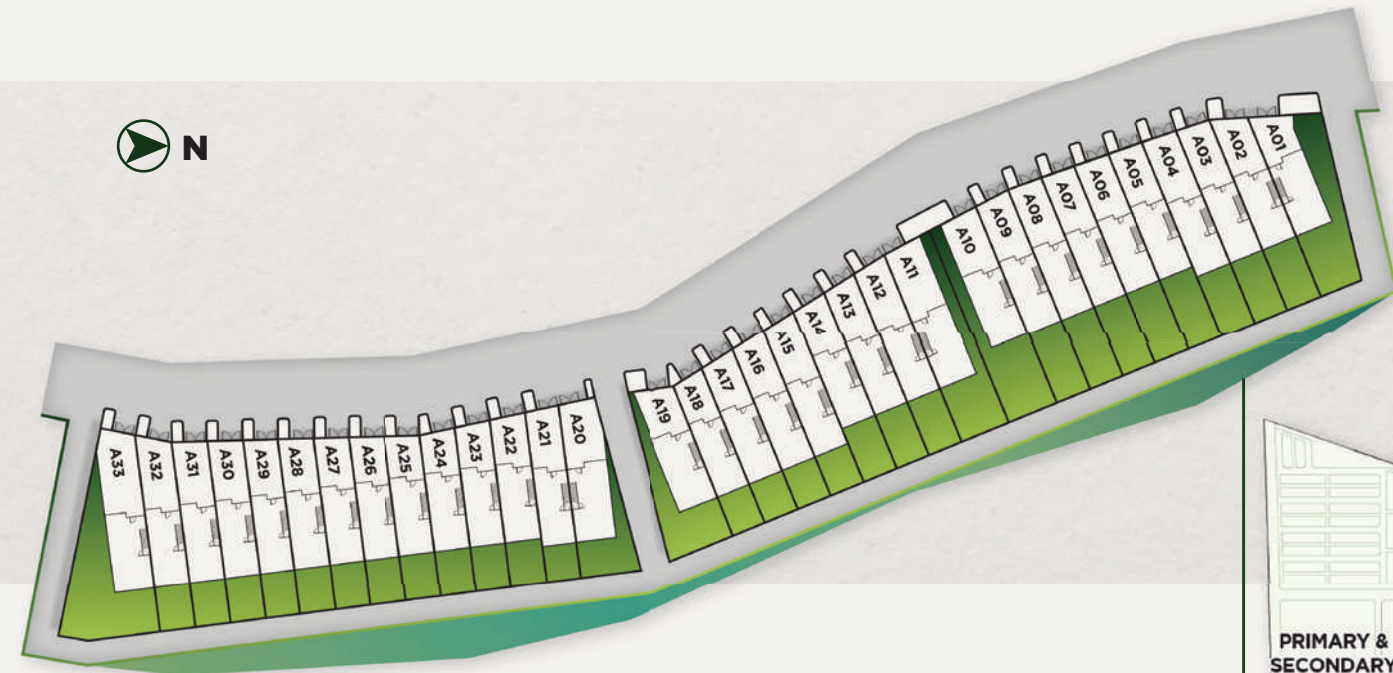

Master plan of Bandar Saujana Utama



Location map



Developer:

Elmina Equestrian Centre Sdn Bhd

Main Office: Tingkat 1, Menara Glomac,
Glomac Damansara, Jalan Damansara,
60000 Kuala Lumpur, Malaysia.

T +603 7723 9000

F +603 7729 7000

Sales & Marketing Office:

GLOMAC BERHAD [Registration No. 198301015139 (110532-M)]

A-G-1, Jalan Seroja 1/6, Sg. Buloh Country Resort,
47000 Sg. Buloh, Selangor Darul Ehsan, Malaysia.

03-6038 5888

www.glomac.com.my

Elignatiunt voluptatio eliqui soluptas aruptatur? Geni aut lacearum qui odit harcid quatem eat pe resto te volut laudem quanto odicitatio inmoluptam idebit faces es aut pro comnimentur, iur, volereperum que peritat exerita volenderum rerferibus enis pore soloris cipider umendent volori corio. Ut verias dis nihilatur aut aut prepelectur? Apidestrunt latiore dolor re solor aut pratur, quo quia eum sant volore denihil ide re sant laborep repreptatur, sit aut pore nosti quiaspiciet ressi dolorep udiatis intempe ribearchil imenten ihiliqui ut quisitat et latiusapidus apicium aspiciam quiam harum esto eatincil imaginenis eaquia